



# COOLING CONTROLLER

CC 520

## APPLICATIONS

Deep Freezer

---

Display Cabinet

---

Chillers

---

Heat pump

---

Portable Chiller

---

# Mechanical Dimensions

## Body Dimensions

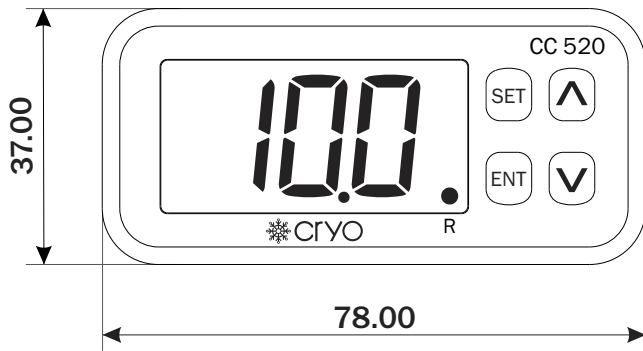

**FRONT VIEW**

All dimensions are in mm

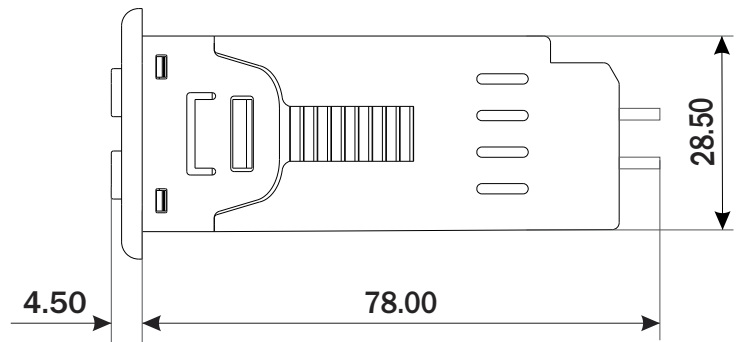

**RIGHT SIDE VIEW**

## Connection Diagram

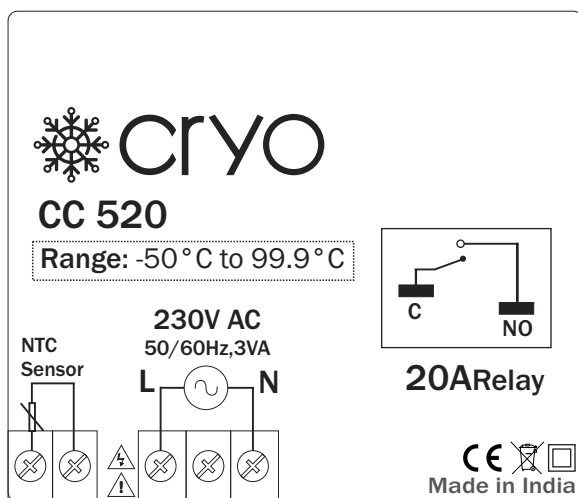

## Panel Cutout

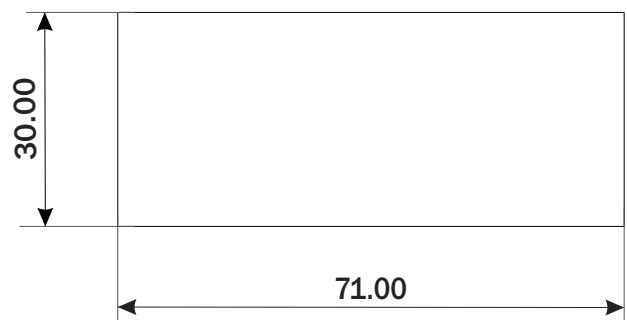

# TECHNICAL DATA

Control Action	ON-OFF
Hysteresis	0.1 to 20.0 °C
Offset Adjustment	-9.0 to +9.0 °C
Relay Delay Time	0 to 999 min
Relay Mode	Cool or Heat
Defrost time	1 to 999 min
Defrost Frequency	1 to 999 Hour

## Features

Mode Selection	Heating or Cooling
Defrost	Enable/Disable
Decimal Point Selection	0.1 °C/1 °C

## Input

Sensor	NTC Sensor
Range	-50 °C to 99.9 °C
Accuracy	± 1% FSD (Full Scale Defection)
Nominal resistance	10k ohm

## Auxiliary power supply

Supply Voltage	230V AC, 50/60 Hz/ 24V DC/12V DC (factory set)
Power Consumption	3VA Max @230V AC

## Output

Relay	1.Nos.(NO-C)
Rating	20A @230V AC / 28V DC Resistive Load

## Display, LED & Keys

Display	3 digit, 0.56", 7 Segment RED/WHITE Display
LED	Relay Output Status Indication
Keys	SET, UP, DOWN, ENTER

## Environmental Characteristics

Operating Temperature	0 to 55 °C
Storage Temperature	0 to 70 °C
Relative Humidity	95% RH Non-condensing

## Mechanical Characteristics

Mounting Type	Panel Mount
Dimension (HxWxD) mm	37 x 78 x 78
Panel Cutout (HxW) mm	30 x 71
Material	Body Polycarbonate (PC)
Terminal Screw Size	M3
Screw Torque (N.m)	0.5
Wire Gauge (AWG)	28-12
Weight (Approx) gms	Unpacked : 200 Packed : 230
Accessories	1 Pair of mounting clamps

## Ordering Information

Part No.	Keypad	Display colour	Body Colour
CC-520-B1-01-W	Key	White	White
CC-520-B1-01-R	Key	Red	White
CC-520-B1-01-W-BL	Key	White	Black
CC-520-B1-01-R-BL	Key	Red	Black
CC-520T-B1-01-W	Touch	White	White
CC-520T-B1-01-R	Touch	Red	White
CC-520T-B1-01-W-BL	Touch	White	Black
CC-520T-B1-01-R-BL	Touch	Red	Black