

LOOP POWERED TRANSMITTER

LPT 45

APPLICATIONS

Field Interface device

Impedance matching of
Transmitters and Receiver

Isolation of field signals

Distribution of signals

Factory automation

Powering of field Transmitters

Mechanical Dimensions

Body Dimensions

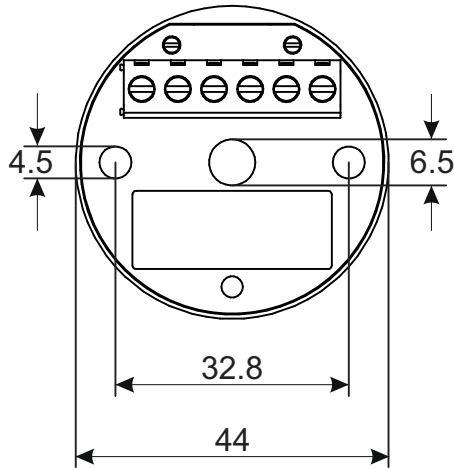

FRONT VIEW

All dimensions are in mm

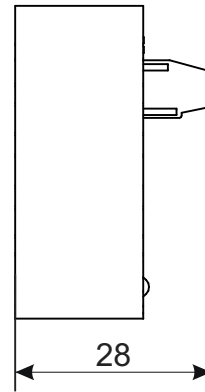

RIGHT SIDE VIEW

Connection Diagram

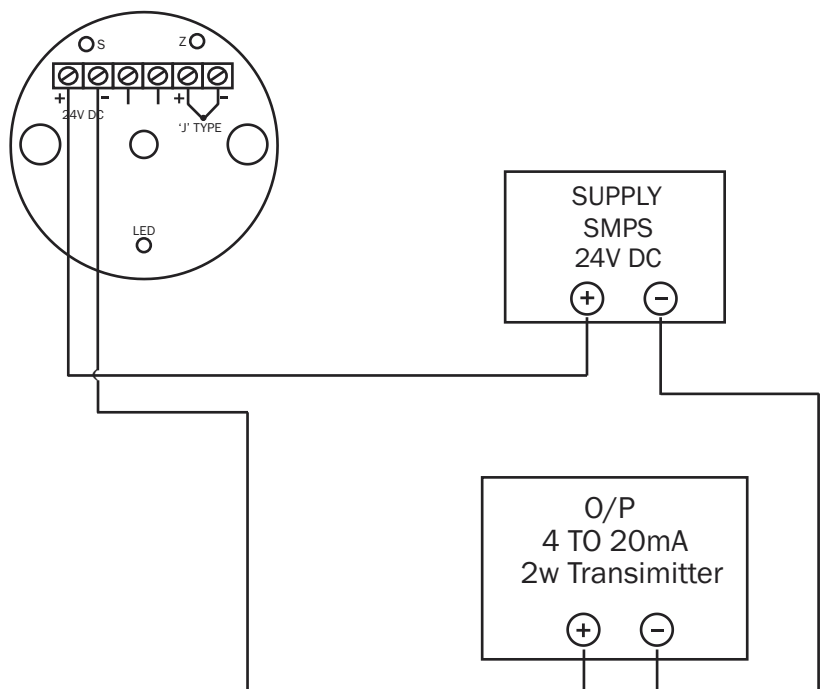
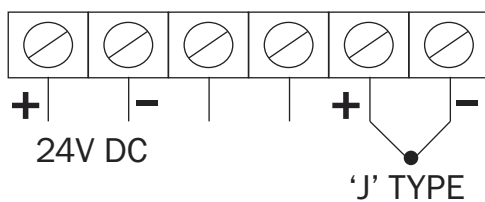

TECHNICAL DATA

Input	Any one Factory Set	Thermocouple : J/K RTD : PT 100/3W
Output		4 To 20mA DC
Power Supply		24V DC
Accuracy		± 1 % FSD

Features

- 1.5KV isolation between supply, input & output
- Linearized O/P
- Zero & span correction facility through trim port
- Fast Response time <150ms
- Din Rail Mounting

Output

Output	Current :4 To 20mA DC
Response Type	<150 msΩ
Output Impedance	> 500Ω

Input

Input	Any one Factory Set	Thermocouple (J/K) RTD : PT 100/3W
Input Impedance		>100KΩ
CMRR		>120 db (Typical)
Temperature Co-efficient		<100 PPM

Environmental

Ambient Temperature	0 to 55 °C
Relative Humidity	95% RH Non-Condensing
Protection	Conformal Coating on PCB

Power Supply

Auxiliary Voltage	24V DC
Power Consumption	less than 2VA
Isolation type	Optical - 3 way

Isolation

Isolation between supply and Input	At least 1.5KV AC for 1 min.
Isolation between supply and Output	At least 1.5KV AC for 1 min.
Isolation between Input and Output	At least 1.5KV AC for 1 min.

Mechanical Characteristics

Dimension (mm)	Diameter	44
	Depth	28
Material	Body	ABS
Terminal Screw Size		M3
Screw Torque (N.m)		0.5
Wire Gauge (AWG)		28 - 12
Weight (Approx) gms		Unpacked : 20 Packed : 50